

North American
Skull Base Society

The World Federation
of Skull Base Societies

34TH ANNUAL MEETING & 9TH WORLD CONGRESS

The Unified Skull Base

February 13-16, 2025 | Sheraton, New Orleans, LA

Pre-Meeting Dissection Course: February 12-14, 2025
Louisiana State University, New Orleans, Louisiana

NASBS LEADERSHIP

PRESIDENT

Erin L. McKean, MD, MBA, FACS

SCIENTIFIC PROGRAM CO-CHAIRS

Shirley Y. Su, MBBS, FRACS & Nickalus R. Khan, MD

PRE-MEETING DISSECTION COURSE CO-CHAIRS

Bharat Guthikonda, MD & Rahul Mehta, MD

WORLD CONGRESS LEADERSHIP

PRESIDENT

Dr. Fernando Dias, MD

CONGRESS PRESIDENT

Dr. Jacques Morcos, MD

PROGRAM CHAIR

Dr. Daniel Prevedello, MD, MBA, FACS

www.nasbs.org

2025 ADVANCE PROGRAM

TRACK CHAIRS

Track Co-Chairs - Anterior Skull Base: Intradura/Intraaxial Tumor

Dr. Paul Gardner
Dr. Shaan M. Raza

Track Co-Chairs - Anterior Skull Base Track: Orbit

Dr. Kris Moe
Dr. S. Tonya Stefko

Track Co-Chairs - Anterior Skull Base: Sinonasal

Dr. Mathew Geltzeiler
Dr. Marilene Wang

Track Co-Chairs - Anterior Skull Base Track: Trauma/Vascular

Dr. Nickalus Khan
Dr. Gabriel Zada

Track Chair - Head and Neck Track: Free Tissue Reconstruction and Facial Reanimation

Dr. Mathew Old

Track Co-Chairs - Head and Neck Track: Nasopharynx Cancer and Sinonasal Sarcoma

Dr. Neal Akhave
Dr. Jack Phan
Dr. Meghan T. Turner

Track Co-Chair - Head and Neck Track: Head and Neck Track: Survivorship and Treatment Effects/Rehabilitation

Dr. Sean Edward

Track Co-Chairs - Lateral Skull Base Track Acoustic Neuroma

Dr. Pamela Roehm
Dr. Michael E. Ivan

Track Co-Chairs - Lateral Skull Base Hearing/Vestibular Rehabilitation

Dr. Christopher J. Farrell
Dr. Simon Angeli

Track Co-Chairs - Lateral Skull Base: Lateral Skull Base Tumors

Dr. Christopher Salvatore Graffeo
Dr. R. Mark Wiet

Track Co-Chairs - Lateral Skull Base Track: Petrous Apex

Dr. Vijay Agarwal
Dr. Erika Woodson

Track Co-Chairs - Sellar and Parasellar Track Craniopharyngioma

Dr. Donato Pacione
Dr. Brian David Thorp

Track Chair - Sellar and Parasellar Track: Chordoma and Chondrosarcoma

Dr. Marvin Bergsneider
Dr. Erin Mckean

Track Co-Chairs - Sellar and Parasellar: Nonfunctional Benign Adenomas

Dr. Mindy Rabinowitz
Dr. Angela Richardson

Track Co-Chairs - Sellar and Parasellar: Pituitary Functional Adenomas

Dr. Andre Beer-Furlan
Dr. Marla Sevilla Alsina

Track Chair - The Middle Ground: AI/Technology

Dr. Jean Anderson Eloy
Dr. James Liu

Track Co-Chairs - The Middle Ground: Career Building

Dr. Corinna Levine
Dr. Jennifer Moliterno Gunel

Track Co-Chair - The Middle Ground: CSF Management

Dr. Edward Kuan
Dr. Jeffrey M. Sorenson

Track Chair - The Middle Ground: Pediatrics Co-Chair

Dr. Uma Ramaswamy
Dr. Anthony W. Wang

Track Co-Chairs - The Middle Ground: Value-based Care

Dr. Varun Kshetry
Dr. Corinna Levine

Rhoton Room Co-Chairs

Dr. Ralph Abi Hachem
Dr. Maria Peris Celda
Dr. Juan Fernandez Miranda

Pre-Meeting Dissection Course Co-Chairs

Dr. Bharat Guthikonda
Dr. Rahual Mehta

Jeopardy Co-Chairs

Dr. Lola Chambless
Dr. Zoukaa Sargi

Marketing Chair

Dr. Sanjeet Rangarajan

Abstracts Co-Chairs

Dr. Linda Bi
Dr. Nyall London

MEETING LEADERSHIP

NASBS BOARD OF DIRECTORS

OFFICERS

PRESIDENT: Erin L. McKean, MD, MBA, FACS

PRESIDENT-ELECT: L. Madison Michael II, MD, FAANS

IMMEDIATE PAST PRESIDENT: Siviero Agazzi, MD, MBA, FACS

VICE PRESIDENT: Zoukaa Sargi, MD, MPH

SECRETARY: Daniel M. Prevedello, MD, MBA, FACS

TREASURER: C. Arturo Solares, MD, FACS

DIRECTORS AT LARGE

Moises Arriaga, MD

Lola Chambless, MD

John de Almeida, MD

Christopher J. Farrell, MD

Juan C. Fernandez-Miranda, MD

Maria Peris Celda, MD, PhD

Shirley Su, MBBS, FRACS

Eric Wang, MD

Claudia Kirsch, MD, FACR, FASFNR

Varun Kshetry, MD

Carlos Pinheiro-Neto, MD, PhD

Jamie Van Gompel, MD

BOARD OF ADVISORS

Ricardo L. Carrau, MD, MBA

James J. Evans, MD, FACS, FAANS

John G. Golfinos, MD

Ian J. Witterick, MD, MSc, FRCSC

Lee Zimmer, MD, PhD

MESSAGE FROM THE PRESIDENT

Dear Colleagues,

Welcome to New Orleans where the Good Times Roll!

I hope that the **34th Annual Meeting** of the **North American Skull Base Society (NASBS)**, along with the **9th World Congress** of the **World Federation of Skull Base Societies** will be an unforgettable time for all of us, bringing us together to discuss the *Unified Skull Base*.

Over the past 12 months, I have worked with our Scientific Program Co-Chairs **Dr. Shirley Su** and **Dr. Nick Khan**, along with **Dr. Jacques Morcos** and **Dr. Daniel Prevedello** of the World Federation (under the presidency of **Dr. Fernando Dias**) and the rest of the Scientific Program Committee (SPC) to bring you the hottest science and innovation in interactive and collaborative formats. The SPC recruited faculty from around the world, and I'm excited to share that we have over 800 speakers! We welcome the World Federation leaders and members, and we are looking forward to learning from you.

The scientific program has been organized in specialty tracks to allow easy navigation and tailoring to your specific interests. Anterior (Ventral) Skull Base, Lateral Skull Base, Head and Neck, Sellar/Parasellar and Middle Ground tracks have organized days to showcase cohesive concepts or pathologies. We are highlighting a new advanced Neuroradiology Day, Chordoma Education Day, Orbit Education Day (following a Rhoton Room orbital session that evening before), Survivorship Day, and more, along with special collaborative sessions with the North American Society of Academic Orbital Surgeons (ASAOS), the Society for Head and Neck Anesthesia (SHANA) and the European Society for Sinonasal Cancer Research (EUSICA/INSICA).



MESSAGE FROM THE PRESIDENT CONT.

Alongside our always sold-out pre-meeting hands-on dissection lab, we will again feature our well-loved and always well-attended Rhoton Room educational sessions and dueling dissections. We also have top-notch guest and keynote speakers. **Dr. Christine Glastonbury** is a Professor of Radiology & Biomedical Imaging, Otolaryngology-Head & Neck Surgery, and Radiation Oncology at the University of California, San Francisco and will be giving our 2nd annual Curtin Call Lecture in honor of former NASBS President Dr. Hugh Curtin. **Leseliey Welch, MPH, MBA**, the co-founder and CEO of Birth Center Equity, will share how she achieved her vision for unified, safe, patient-centered care despite numerous barriers and resistance.

This year's Honored Guest Speakers are mentors of mine, who have shaped numerous careers and innovations in skull surgery. **Dr. Lawrence Marentette** is the Professor Emeritus in the departments of Otolaryngology, Neurosurgery, and Oral & Maxillofacial Surgery at the University of Michigan, USA. I had an opportunity to sit down with Larry at his home and interview him, culminating in a memorable video and a 'big fish' story. **Dr. Karin Muraszko** is a Professor and former Chair of the Neurosurgery Department at the University of Michigan and will share her experience to and in leadership. And finally, **Dr. Carol Bradford**, Dean of the Ohio State University School of Medicine and Professor of Otolaryngology – Head and Neck Surgery, is a trailblazer in head and neck oncology, working to study HPV in head and neck cancer before an epidemic of cases worldwide. She has been a mentor of mine since medical school, and she will share stories from her groundbreaking work as a surgeon, researcher, educator and leader.

Finally, I am confident that New Orleans' southern hospitality will make this meeting a perfect occasion to make new friends, reconnect with old acquaintances, and continue to collaborate across specialties and borders. We have multiple social events this year, kicking off with a World Federation welcome at the Crescent City Brewhouse, where you'll enjoy live jazz, authentic cuisine, oyster shucking, in-house brewed beer, and a balcony with stunning river views. Our main social event will take place at the iconic House of Blues where you will experience the Jake Landry band, a live New Orleans band that brings us the heart of the city. You'll be able to tour the full venue and connect in this joyful space. We will celebrate this beautiful city that has experienced terrible loss but continues to show tremendous compassion, resilience and love.

It has been an honor and privilege to serve as your president. Laissez les bons temps rouler!

Sincerely,



Erin McKean, MD, MBA, FACS
NASBS President 2024-2025

SPEAKERS

[Learn more about our lineup of speakers here](#)

Keynote Speaker | Leseliey Welch, MPH, MBA

Curtin Call Speaker | Christine M. Glastonbury, MBBS

Honored Guest Speakers

Carol R. Bradford, MD, MS, FACS

Lawrence J. Marentette, MD

Karin Muraszko, M.D, FAANS



GENERAL INFORMATION

TABLE OF CONTENTS

Track Chairs	2
Meeting Leadership.....	3
Message from the President	3
Speakers	5
General/CME Information	6
General Information	7
Meeting Hours.....	9
Floor Plans.....	10
Program & Agenda.....	12
Abstracts.....	12
Sponsors and Supporters	13
Exhibitors	14
Disclosures.....	15

CONTACT

North American Skull Base Society
11300 W. Olympic Blvd., Suite 600
Los Angeles, California 90064
Phone: 310-424-3326
FAX: 310-437-0585
www.nasbs.org

HOTEL CONTACT

Sheraton, New Orleans
500 Canal Street | New Orleans, LA 70130
1 504-525-2500

NASBS IS MANAGED BY BSC MANAGEMENT, INC.

11300 West Olympic Blvd., Suite 600
Los Angeles, CA 90064
Phone: 310-437-0555, Ext. 101
FAX: 310-437-0585
E-Mail: info@bscmanage.com
www.bscmanage.com

CME INFORMATION

NASBS 2025 ANNUAL MEETING CME ACCREDITATION STATEMENT

CONTINUING MEDICAL EDUCATION CREDIT INFORMATION

Accreditation

This activity has been planned and implemented in accordance with the accreditation requirements and policies of the Accreditation Council for Continuing Medical Education (ACCME) through the joint providership of American College of Surgeons and North American Skull Base Society. The American College of Surgeons is accredited by the ACCME to provide continuing medical education for physicians.

AMA PRA Category 1 Credits™

The American College of Surgeons designates this live activity for a maximum of **24.0** AMA PRA Category 1 Credits™. Physicians should claim only the credit commensurate with the extent of their participation in the activity.



Award of CME credits by ACS is based on compliance of the program with the ACCME accreditation requirements and does not imply endorsement by ACS of the content, the faculty, or the sponsor of the program.

GENERAL INFORMATION

ANNUAL MEETING OBJECTIVES

Upon completion of this course, participants will be able to:

- Understand and explain most recent recommendations for management of skull base pathology
- Describe recent advances in instrumentation and technology in skull base surgery
- Gain knowledge in challenging skull base pathology from experienced leaders in the field
- Collaborate in multidisciplinary working groups to identify state of the art management for select skull base pathology
- To gain knowledge on optimal technical surgical management of complex skull base pathology through video analysis and expert critique of intraoperative video
- Establish consensus statement on management of complex skull base pathology through review of existing medical literature

WHO SHOULD ATTEND

The NASBS meeting is open to NASBS members and non-members.

TARGET AUDIENCE

- Otolaryngologists, head and neck surgeons, neurosurgeons, reconstructive surgeons, radiation oncologists, radiologists, medical oncologists, physical rehabilitation physicians, ophthalmologists, neurologists, maxillofacial surgeons, maxillofacial prosthodontists and endocrinologists
- Targeted allied health professionals include physical therapists, oncology nurses, oral health specialists, occupational therapists, speech and language pathologists, optometrists and psychologists

DISCLOSURE INFORMATION

Ineligible Company: The ACCME defines an “ineligible company” as any entity producing, marketing, re-selling, or distributing health care goods or services used on or consumed by patients. Providers of clinical services directly to patients are NOT included in this definition.

Financial Relationships: Relationships in which the individual benefits by receiving a salary, royalty, intellectual property rights, consulting fee, honoraria, ownership interest (e.g., stocks, stock options or other ownership interest, excluding diversified mutual funds), or other financial benefit. Financial benefits are usually associated with roles such as employment,

management position, independent contractor (including contracted research), consulting, speaking and teaching, membership on advisory committees or review panels, board membership, and other activities from which remuneration is received, or expected. ACCME considers relationships of the person involved in the CME activity to include financial relationships of a spouse or partner.

Conflict of Interest: Circumstances create a conflict of interest when an individual has an opportunity to affect CME content about products or services of an ineligible company with which he/she has a financial relationship.

GENERAL INFORMATION

The ACCME also requires that ACS manage any reported conflict and eliminate the potential for bias during the educational activity. Any conflicts noted below have been managed to our satisfaction. The disclosure information is intended to identify any commercial relationships and allow learners to form their own judgments. However, if you perceive a bias during the educational activity, please report it on the evaluation.

In accordance with the ACCME Accreditation Criteria, the American College of Surgeons must ensure that anyone in a position to control the content of the educational activity (planners and speakers/authors/discussants/moderators) has disclosed all financial relationships with any commercial interest (termed by the ACCME as “ineligible companies”, defined on the previous page) held in the last 24 months. Please note that first authors were required to collect and submit disclosure information on behalf of all other authors/contributors, if applicable. Full listing found on **page 14**.

MEMBERSHIP BENEFITS

- Active members will receive the official journal of the society, The Journal of Neurological Surgery Part B, a publication that contains peer reviewed original articles, review articles, and position papers. It also presents news and information on an international scope to keep members aware of recent and upcoming events, activities, and evolving developments in skull base surgery. Affiliate, International and Candidate members may subscribe to the journal for \$100 annually.
- Discounted rates to attend the Annual Meeting
- Opportunities to network with colleagues and experts from across North America and globally
- Committees which provide opportunities for camaraderie, involvement and leadership development
- Online access to all members’ contact information.

Please visit www.nasbs.org/membership for more information or email membership@nasbs.org.

For information on membership, visit the Membership table near registration at the NASBS 2025 Annual Meeting.

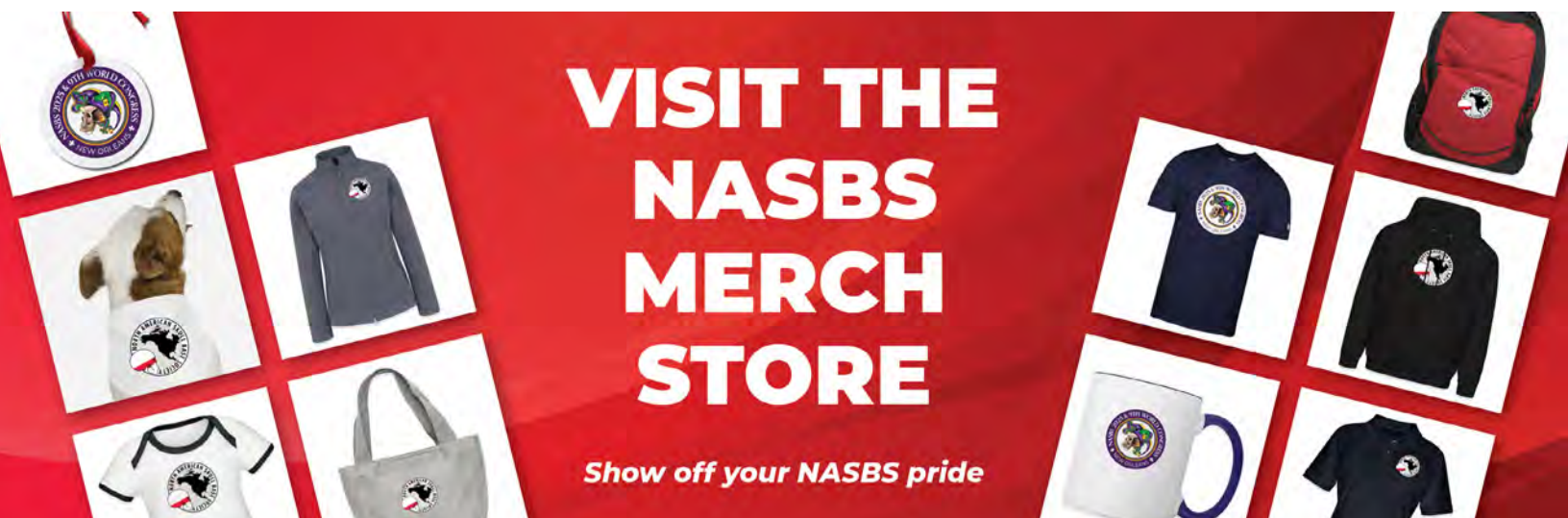

**VISIT THE
NASBS
MERCH
STORE**

Show off your NASBS pride

The advertisement features a collage of various merchandise items including t-shirts, hoodies, mugs, and bags, all featuring the NASBS logo. The items are displayed against a red background with white borders. The central text is in large, bold, white letters, and the tagline is in a smaller, italicized font.

MEETING HOURS

REGISTRATION HOURS

Registration located in Grand Chenier

Wednesday, February 12, 2025
2:00 pm – 6:00 pm

Thursday, February 13, 2025
7:00 am – 6:00 pm

Friday, February 14, 2025
7:00 am – 6:00 pm

Saturday, February 15, 2025
7:00 am – 6:00 pm

Sunday, February 16, 2025
7:00 am – 11:00 am

EXHIBIT HALL/POSTER HOURS

Exhibit Hall located in Napoleon Ballroom

FRIDAY, FEBRUARY 14, 2025

Exhibits/Posters
9:00 am to 4:00 pm

Welcome Reception Happy Hour
6:05 pm to 7:35 pm

*Morning Refreshments, Breaks, and Lunch
will be available in the Exhibit Hall*

SATURDAY, FEBRUARY 15, 2025

Exhibit Hall Open
9:00 am to 4:00 pm

*Morning Refreshments, Breaks, and Lunch
will be available in the Exhibit Hall*

WFSBS RECEPTION

Thursday, February 13, 2025
Crescent City Brew House
7:00PM - 10:00PM

[Directions Here](#) or [Scan the QR Code Below](#)



WELCOME RECEPTION

Friday, February 14, 2025
Exhibit Hall -
Napoleon Ballroom
6:05PM -7:35PM

MAIN SOCIAL EVENT

Saturday, February 15, 2025
7:30PM -10:00PM
House of Blues

[Directions Here](#) or [Scan the QR Code Below](#)



FLOOR PLANS

2ND FLOOR

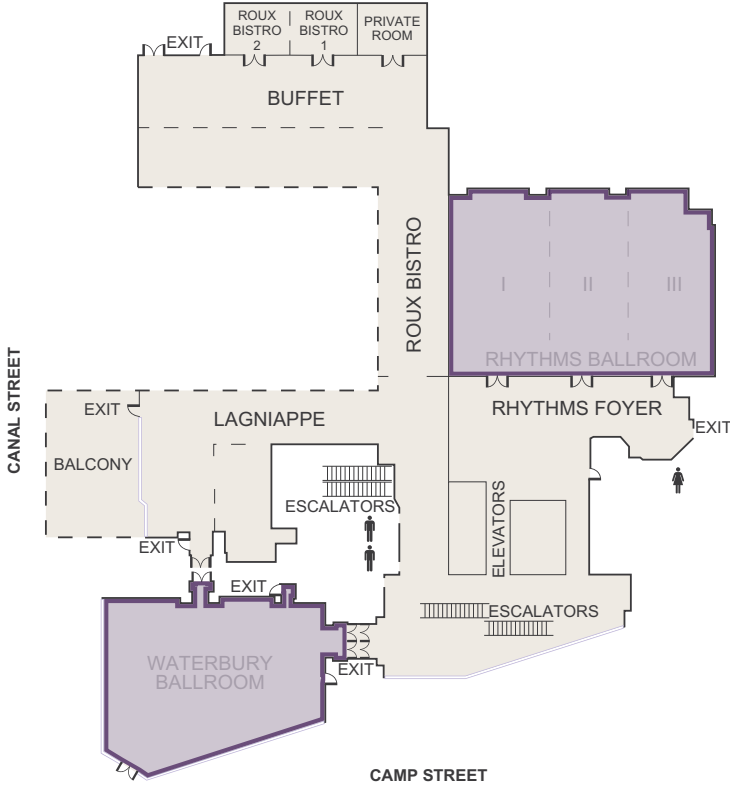

3RD FLOOR

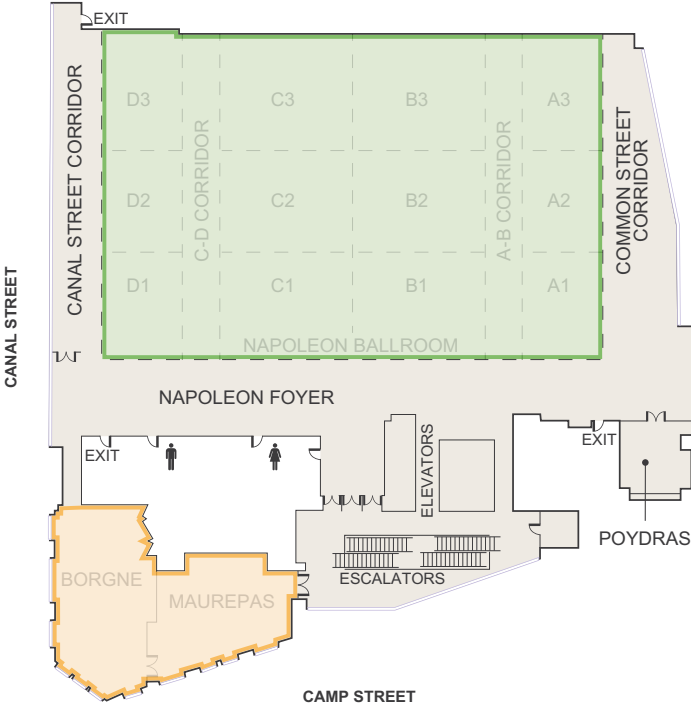

FLOOR PLANS

4TH FLOOR

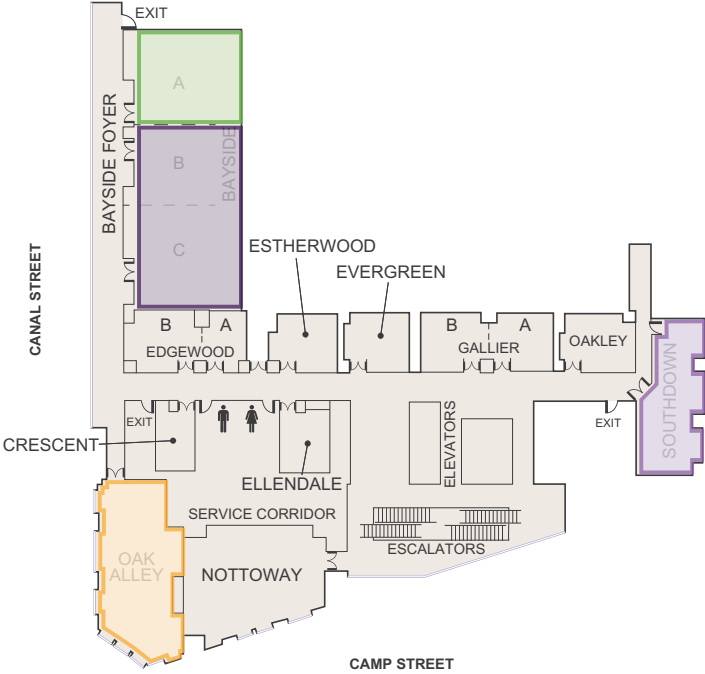

5TH FLOOR

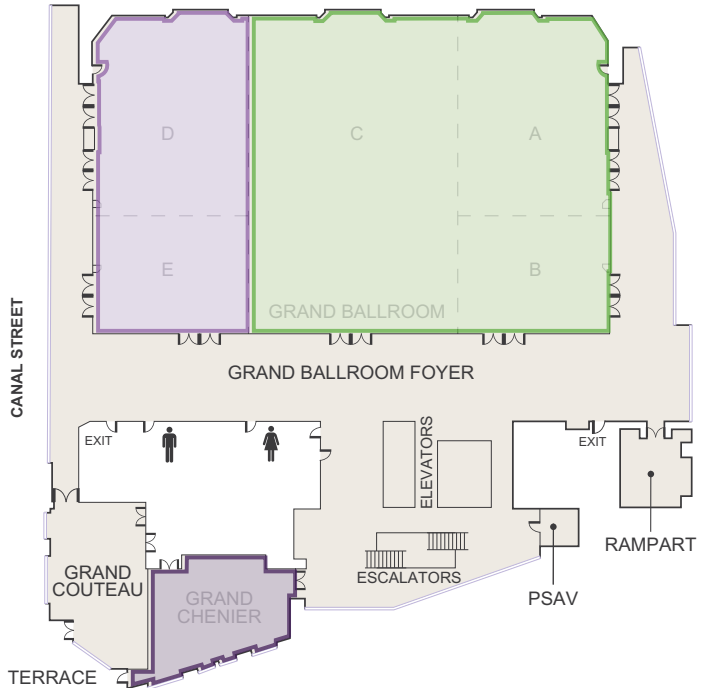

PROGRAM & AGENDA

At-A Glance Program

Advanced Program

Dissection Pre-Course at LSU

ABSTRACTS

Proffered Presentations

Posters



The North American Skull Base Society would like to thank the following companies and institutions for their support:

MARKETING SUPPORT

DIAMOND VISIBILITY SPONSOR

Stryker

EDUCATIONAL GRANT SUPPORTERS

PLATINUM LEVEL

Mizuho America, Inc.

GOLD LEVEL

KARL STORZ United States
Medtronic

BRONZE LEVEL

Carl Zeiss Meditec, Inc.
Integra LifeSciences
ZIMMER

SPONSORS

SILVER

Dr. Stephen Sullivan and Dr. Erin McKean
Mayo Clinic Skull Base Team - Rochester, Minnesota
Michigan Medicine
Tampa General Hospital / USF Health
University of Miami Health System / Department of
Otolaryngology -
Head and Neck Surgery

BRONZE

The Ohio State University Comprehensive Cancer Center –
James Cancer Hospital and Solove Research Institute

The North American Skull Base Society would like to thank the following companies and institutions for their support:

SPONSOR – WOMEN IN SKULL BASE SURGERY RECEPTION

Medtronic

SPONSORS - MAIN SOCIAL EVENT

MARDI GRAS SPONSOR

Michigan Medicine

KING CAKE SPONSOR

Tampa General Hospital/USF Health

PRE-MEETING DISSECTION COURSE - EDUCATIONAL GRANT SUPPORT

Axogen, Inc.

Integra LifeSciences

Stryker

The NASBS thanks the following companies for their support of the Pre-Meeting Dissection Course and Rhoton Room Dueling Dissections through in-kind equipment donations:

Axogen, Inc.

Carl Zeiss Meditec, Inc.

Integra LifeSciences

KLS Martin

Medtronic

Mizuho America, Inc.

MUTOH AMERICA Co. Ltd.

Olympus America, Inc.

Peter Lazic U.S., Inc.

SPIWAY, LLC

Stryker

EXHIBITORS

[Find booth locations and more about our sponsors here](#)

DISCLOSURES

Please click the links below to see the complete disclosure lists for this program.

[Annual Meeting | Pre-Meeting Dissection Course](#)

NASBS 2025 PRE-MEETING DISSECTION COURSE CME ACCREDITATION STATEMENT

CONTINUING MEDICAL EDUCATION CREDIT INFORMATION

Accreditation

This activity has been planned and implemented in accordance with the accreditation requirements and policies of the Accreditation Council for Continuing Medical Education (ACCME) through the joint providership of American College of Surgeons and North American Skull Base Society. The American College of Surgeons is accredited by the ACCME to provide continuing medical education for physicians.

AMA PRA Category 1 Credits™

The American College of Surgeons designates this live activity for a maximum of **7** AMA PRA Category 1 Credits™. Physicians should claim only the credit commensurate with the extent of their participation in the activity.



NASBS Skull Base Surgery SUMMER WORKSHOP



August 14-17, 2025 • LSU Health Sciences Center, New Orleans, LA

SAVE THE DATE

The NASBS Summer Course is a premier educational opportunity tailored for Senior Neurosurgery Residents and Otorhinolaryngology/Head & Neck Fellows who are pursuing advanced skills in Skull Base Surgery

This course is not to be missed! Registration will be first come, first served, and opens April 2025. For more information visit <https://www.nasbs.org/summer-course/> or contact NASBS Course Coordinator, Meghan Nabors meghan@nasbs.org.

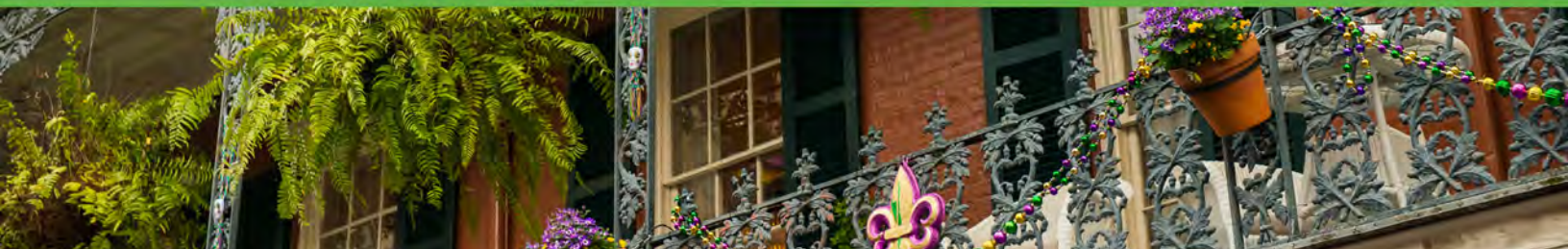



SAVE THE DATE

NASBS 2026

*scan me to save to
your calendar*



March, 6 – 8, 2026



San Diego, CA | Town and Country

